

# Outdoor Shades USA ZIP INSTALLATION INSTRUCTIONS



## **PLEASE NOTE: FASTENERS ARE NOT INCLUDED**

Thank you for purchasing an Outdoor Shades USA Zip Exterior Cassette Solar Screen. Whether you are an experienced installer or this is your first installation, it's suggested to read these instructions carefully before attempting the installation.

Before you start, take a minute to ensure your installation will proceed as smoothly as possible.

- Make sure you have all the tools needed
- Measure the screen and make sure it will fit in the desired space
- 2-3 People are needed for installation
- Open the box and lay out all the components

# Tools Needed



Tape Measure



Chop saw



Non-Ferrous  
Metal Blade



Exterior Rated  
Screws



6 Foot Level



Cordless Drill



Cordless Impact



Impact Driver Set



Metal/Wood Drill Bit's



3 Prong Plug



2-3 Ladders



Dry Lube



Mallet



Caulk Gun



Exterior Caulk



Masonry Drill Bit's for Stucco, etc.

# Optional Tools

or Cement/Stone Installation falls



Hammer Drill



Concrete Anchors



Mortar Mix to Fill  
Cracks between  
Brick or Stone



Exterior Rated  
Pipe used for Spacing  
Track

# Installation Instructions



Your box has arrived, YAY. Your dreams of owning the best outdoor shading product on the market is about to become a reality. Although extremely rare it is possible your merchandise can come in damaged.

1) Inspect your box for any damage. Notate this damage on the Bill of Lading and contact us immediately. Take pictures and email to us.(FIG 1)



2) Unpack box and inspect shade for any damage at this point. Again, contact us immediately. Take pictures and email to us.(FIG 2)



3) It is most likely, we have a 99.9% non damage record, that your shade has in fact come in perfect condition.

4) Remove foam packaging and set aside. Go ahead and remove plastic wrap being **EXTREMELY CAREFUL** not to use a razor blade near the screen fabric.(FIG 2)

5) Remove the two screws holding on the front panel. Set these two screws aside in a safe place. They are the last things to put back on so easy to forget. (FIG 3)

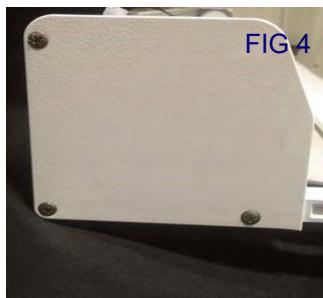

6) Remove front cover and set aside in safe place out of direct sun. This cover can get very hot at the end of the day.

7) Remove the Yellow clip on idle side of roller tube. Then remove the metal ring that holds the motor to the housing.



FIG 5

8) Remove screen roller tube and place on foam packaging that was provided (FIG 5)

9) With the fabric roll removed, Pre-drill 2-3 holes 1" in from end cap of cassette on each side. This can be on the back of cassette(pictured), top of cassette or even into the side of the cassette, depending on installation.(FIG 6)

10) Get your 2 ladders situated below your mounting point with screws and drill ready.



FIG 6

11) With your partner, raise the cassette box into position and screw the top screw in on only one side. Do not tighten completely down.(About 1/8" of play) You might have to pre-drill if drilling in metal, concrete board, stucco, etc. Use appropriate drill bit per application.

12) The person that just attached their side of the box will need to reposition their ladder to the middle of the cassette box to check level. With the 6' level in place move the box up or down the get a perfect level. The screen will not operate correctly if not level. (FIG 7)

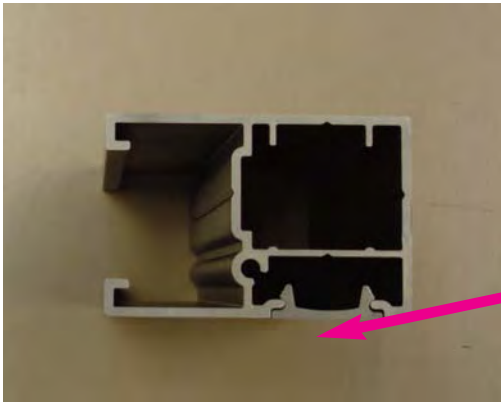

FIG 7

13) The second partner will now screw in their top side of the box. Again not completely tight. (About 1/8"of play) Check level one more time to make sure it didn't move. Adjust if necessary.

14) At this time the box should only have the top screw in on each side, not completely tighten. Next up, is installing the tracks. Go ahead and look at track diagram for tips.

# Shades USA Zip Track



Aluminum Cover Strip  
for Surface Mounting

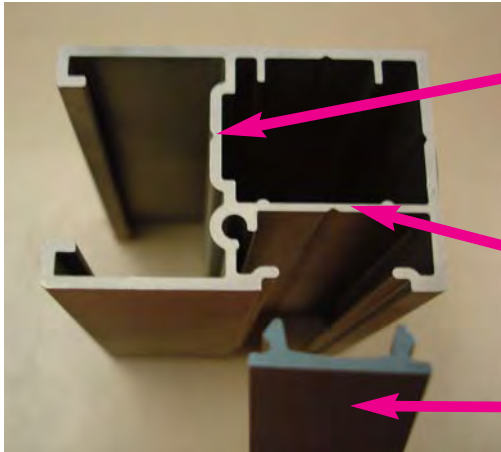
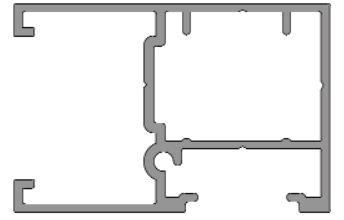

For Recessed or  
Side Mount - Attach  
Here (Pre-Drill First)

For Wall/Fascia  
Mount - Attach Here  
(Pre-Drill First)

Aluminum Cover  
Strip Shown  
Before Insertion

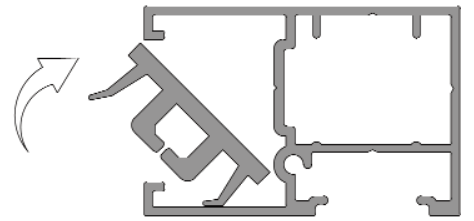

For Recessed Mount:  
Zipper Guides Inserts  
like this

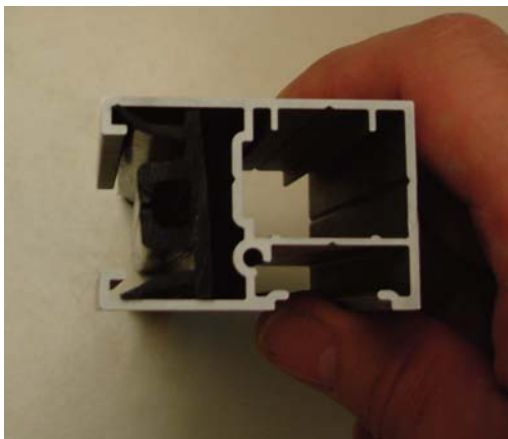
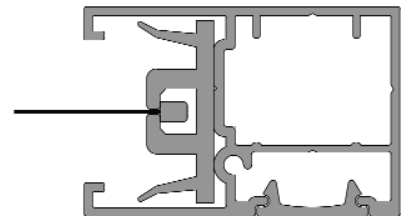
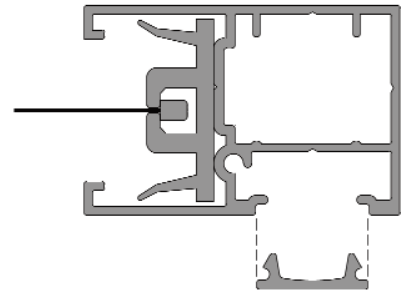

# Outdoor Shades USA Zip Installation Instructions

## Tracks Installation

TOP



### Step #1

Measure side tracks. In most installations the ground is not level and will require each track to be a different length to ensure the housing assembly is level.

**A)** Separate the zipper insert from the aluminum track by sliding it out of the top track.

**B)** Cut **ONLY** the aluminum tracks and covers to your measurement.

**C)** Flip over the zipper insert and cut it from the bottom -NOT the top. The top of the zipper insert has a necessary "V" cut which needs to be reinstalled at the top (FIG 1) of the track to allow the fabric to enter the zipper insert properly. **CAUTION: Cut insert slowly or it could chip.**

**D)** Install Zipper Insert into track now if installing wall mount. If installing tracks side mount then install inserts after Step #4



### Step #2

Pre-Drill Holes in tracks depending on mounting location.

Reference above page for direction of holes.

Drill 6" from top of track and every 3-4 feet. See Below.

### Step #3

Attach the tracks to the cassette box by Inserting the track in the leg of the end cap. (FIG 2)

### Step #4

Anchor with a fastener through the top of each track, 6" below the top. Fasten bottom fastener of left track only. Make sure left track is plumb. **En-sure tracks are parallel and square.**

**Measure across the top and bottom from one side to another (FIG 3).** Make sure the bottom and top measurement are the same and install re-maining fasteners.

**(Spray down inserts with DRY LUBE)**



### **IMPORTANT NOTE**

#### **TRACK ATTACHMENT:**

up to 5' drop: 2 mounting points per track

over 5' drop: 3 mounting points per track

over 10' drop: 4 mounting points per track



**IMPORTANT: DO NOT LEVEL DOWN EACH TRACK SEPARATELY. THE DISTANCE BETWEEN BOTH TRACKS NEED TO BE THE SAME. IMPROPER INSTALLATION WILL NOT LET THE SCREEN OPERATE PROPERLY.**

# Outdoor Shades USA Zip Installation Procedures

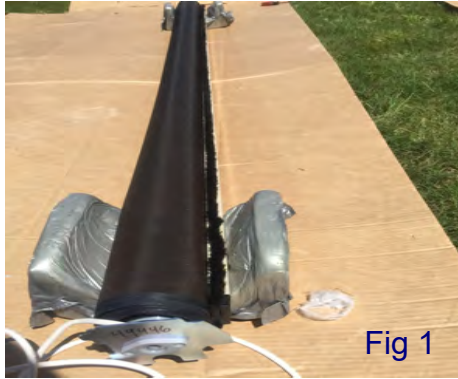

Fig 1

- 1) Attach all screws and tighten on tracks and cassette box.
- 2) Make sure the hole for the motor wire is where you want it. If not this would be the time to drill a new hole. Make sure this hole lines up with the notches on the motor plate.

- 3) Position both ladders under each end of cassette box again. Get ready to lift screen roll into position. (Fig 1)

- 4) Notice the angle of the motor plate and design that will fit inside the cassette end cap. Make sure this is lined up when you go up the ladder.

- 5) Take the roller tube up the ladders. At this time it is easiest to start feeding your motor wire into its exit hole as much as you can before you attach either end of the roller tube.

- 6) The person with the motor side will attach his part first.(FIG 2)

- 7) Finish pulling the wiring through the hole. Line up the motor plate into the cassette and slide in. (Fig 3) **Neither person should ever let their hand off the screen roller tube. You do not want to drop it.**

- 8) The above can be one of the harder parts of the install. You might not have lined the plate up correctly or the motor cord is stuck behind the plate. Go ahead and pull it out again and make sure you are rested before trying again.

- 9) Next Slide the retaining clip onto the idler pin. (FIG 3)

- 10) Then you will slide the clip into the groove until the roller tube clicks into place. (FIG 4)

- 11) At this time slide the bottom bar zipper into the zipper insert by lifting the bottom bar and then dropping it down into the insert. You might have to use a flat head screwdriver here to push the insert to the zipper on the fabric.

- 12) Now it's time to program the remote to the motor and set the limits. We will usually just temporarily plug in the motor using a 3-wire plug. Follow the directions below for programming.



FIG 2



FIG 3

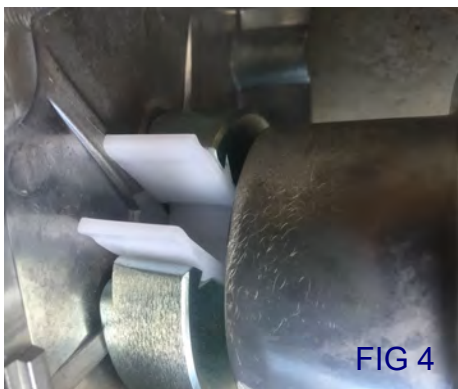

FIG 4

# ALTUS 6 STEP VISUAL REFERENCE GUIDE

## STEP 1

Before programming the motor initiate programming by pressing both the **UP** (▲) and **DOWN** (▼) buttons at the same time until the motor jogs.

**NOTE:** After every command the motor will jog to confirm.

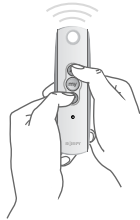

## STEP 2

Check the direction of operation. Press and hold the **DOWN** (▼) button and confirm it moves the motor out (the motor will be in momentary fashion). To change the direction press and hold the **MY** (my) (stop) button until the motor jogs.

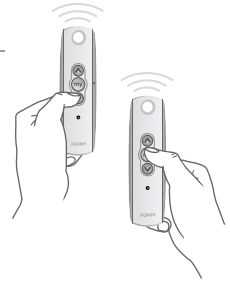

## STEP 3

Bring the motor to your desired upper limit. Press and hold the **MY** (my) (stop) and **DOWN** (▼) buttons until the motor moves DOWN, then release. Stop the motor where the LOWER limit should be set, you can adjust by pressing the (▲) or (▼) buttons.

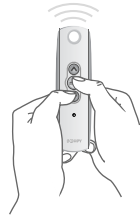

## STEP 4

Press and hold the **MY** (my) (stop) and **UP** (▲) button of the remote to move the motor to the desired upper limit position, then release. The motor will stop at the original upper point. Adjust if necessary.

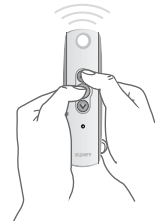

## STEP 5

Press and hold the **MY** (my) (stop) button until the motor jogs to confirm the limit setting.



## STEP 6

Press and hold the **Program** button on the back of the transmitter until the motor jogs. It will now operate in a maintained fashion. Double check limits as a precaution.

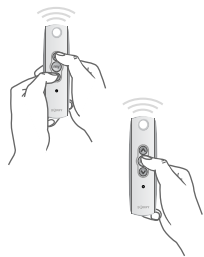

### To Adjust Limits

**To change the limit:** Move the motor to its current lower limit position and let it stop. Press the **UP** (▲) and **DOWN** (▼) buttons simultaneously until the motor jogs, then release. Adjust to a new lower limit position. Press the **MY** (stop) button until the motor jogs, then release. Check new limit.

**To change the upper limit:** Move the motor to its current upper limit position and let it stop. Press the **UP** (▲) and **DOWN** (▼) buttons simultaneously until the motor jogs, then release. Adjust to a new upper limit position. Press the **MY** (stop) button until the motor jogs, then release. Check new limit.



**To add a remote/channel or sun and wind sensor:** First press the programming button on the back of the already programmed remote until the motor jogs. Then press the programming button on the remote that you would like to add until the motor jogs. Check it.

**To reset the motor:** you will need to disconnect power (120vac) for 2 seconds, reconnect for 10 seconds, disconnect for another 2 seconds and reconnect. The motor should start to move and then stop on its own (if this does not happen, continue to perform the disconnects until it does). Once the motor stops moving on its own, press and hold the programming button on the back of the remote and count to ten without letting go. The motor should jog twice.

Please contact SOMFY for detailed installation instructions.  
877-22SOMFY [www.somfysystems.com](http://www.somfysystems.com)





# Outdoor Shades USA Installation Procedures

- Final Steps:**
- 1) Attach the cassette cover to the cassette with the 2 screws provided (FIG1)  
Slide the cover into the groove on top of cassette and push down.
  - 2) Using the mallet attach the track cover strip. (FIG 2)
  - 3) At this time finish up the electrical with a licensed electrician.  
Make sure to not cut motor cord less then 2' long.
  - 4) Make sure you caulk the tracks and box with the appropriate color.

**(90% of the jobs we do are wired into the attic. The other 10% involve some electrical conduit run to an exterior outlet which you can paint to give it a finished look. We use 1/2" metal conduit. )**

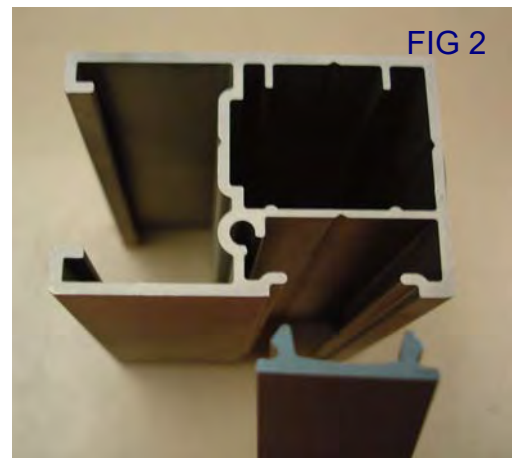
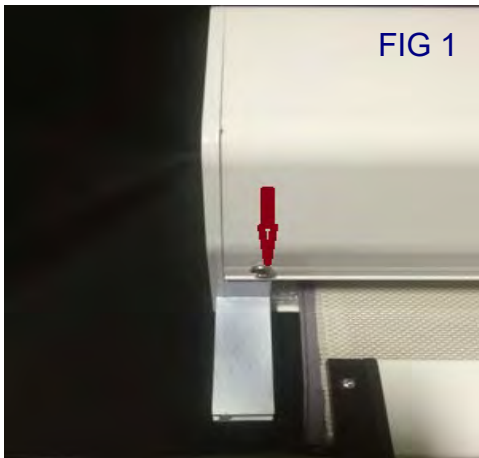

**Congratulations you are now on your way to enjoying the best shade in the USA!!!**

# Outdoor Shades USA Zip Components (4" & 5")

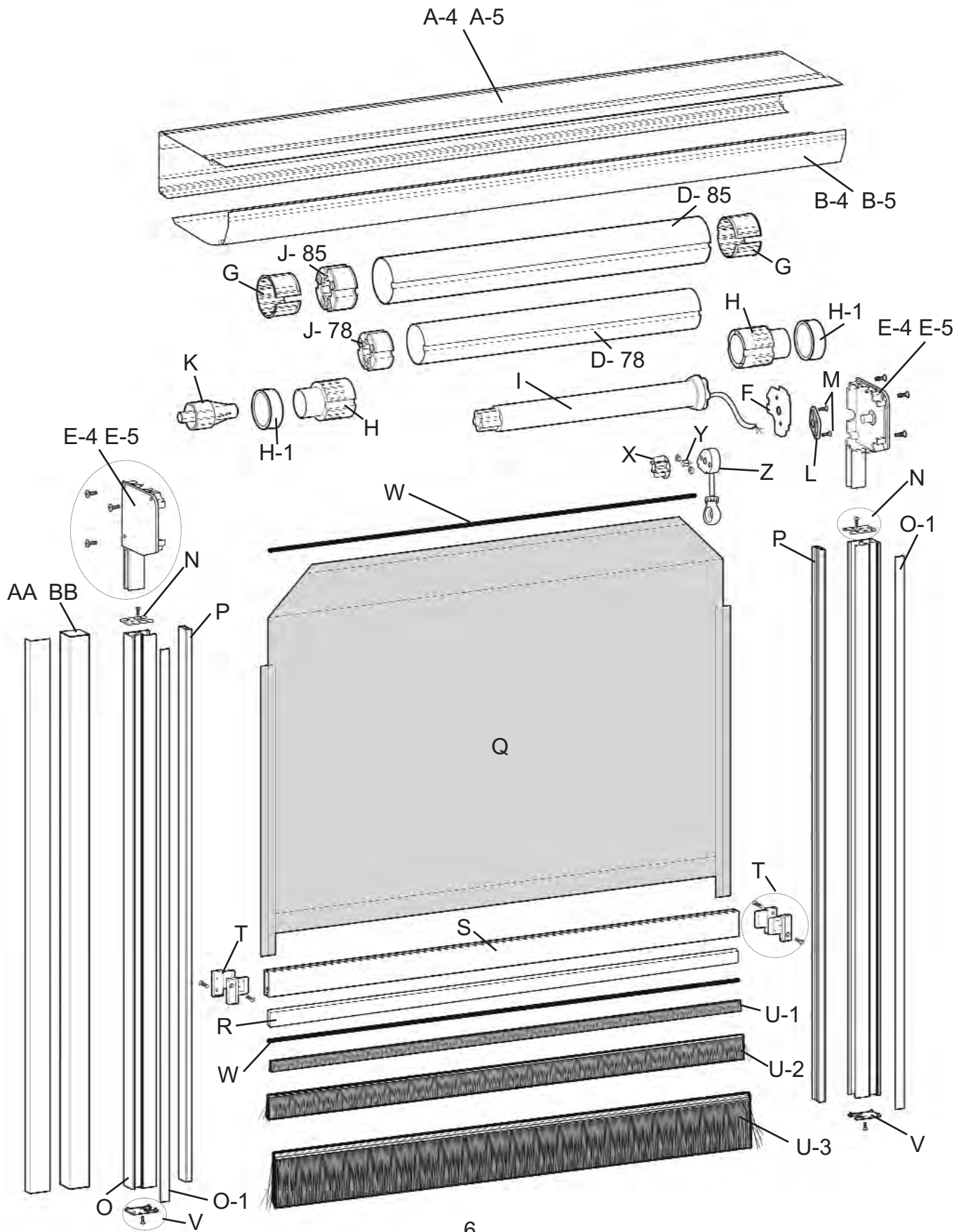

# Outdoor Shades USA Zip Components (4" & 5")

Identification	Description
A-5	Back Section Piece 5" Cassette Box Extrusion - per foot
A-4	Back Section Piece 4" Cassette Box Extrusion - per foot
B-5	Front Section Piece 5" Cassette Box Extrusion - per foot
B-4	Front Section Piece 4" Cassette Box Extrusion - per foot
D-78	78mm Roller Tube - per foot
D-85	85mm Roller Tube - per foot
E-5	5" Cassette End Caps - per pair w/ screws
E-4	4" Cassette End Caps - per pair w/ screws
F	Universal Motor Plate, each
G	85mm Roller Tube Adaptor, each
H	78mm Roller Tube Reducer, each
H-1	Reinforcement Ring, each
I	Altus Motor - sizes varies based on unit size
J-78	78mm Drive Wheel, each
J-85	85mm Drive Wheel, each
K	Spring Loaded Pivot End Pivot, each
L	Distance Spacer, each
M	Motor ONLY Mounting Screws (2)
N	Top Track Stops with Screw, each
O	Standard Track WITH Cover- per foot, each
O-1	Track Front Cover ONLY, per foot, each
P	Zipper Track Insert - per foot, each
Q	Fabric Cover - see recover pricing chart
R	2 Piece Hem Bar Weight - per foot
S	Hem Bar Extrusion ONLY - per foot
T	Hem Bar Glider Assembly - per side with hardware
U-1	0.375" Hem Bar Pile - per foot
U-2	0.75" Hem Bar Brush - per foot
U-3	1.50" Hem Bar Brush - per foot
V	Bottom Track Cap with Hardware, each
W	PVC Spline (same for hem bar and roller tube) - per yard
X	Gear Gudgeon, each
Y	12mm to 7mm Drive Pin, each
Z	5:1 Manual Gear with Hardware, each
AA	"L" Chanel - per foot
BB	1" x 2" Fur Out Strips - per foot

# Radio Technology Somfy® RTS > LT50 Altus® RTS



## LT50 Altus® RTS Star Head

<b>506S2</b>	1032500	<b>535A2</b>	1037509
<b>510S2</b>	1037501	<b>540R2</b>	1037510
<b>525A2</b>	1043287	<b>550R2</b>	1037511
<b>530R2</b>	1037507		

Radio Technology Somfy® (RTS) allows for wireless radio control of motorized window coverings via the RTS family of controls.

### Technical features

<b>Voltage Supply</b>	AC
<b>Index Protection Rating</b>	IP 44
<b>Limit Switch Type</b>	Electronic RTS
<b>Limit Switch Capacity</b>	250 Turns

<b>Temperature Working Range</b>	14°F to 104°F (-10°C to 40°C)
<b>Insulation Class</b>	Class 1 for 120V
<b>Antenna</b>	Integrated into power cord. Must be at least 12 inches and must not come in contact with metal

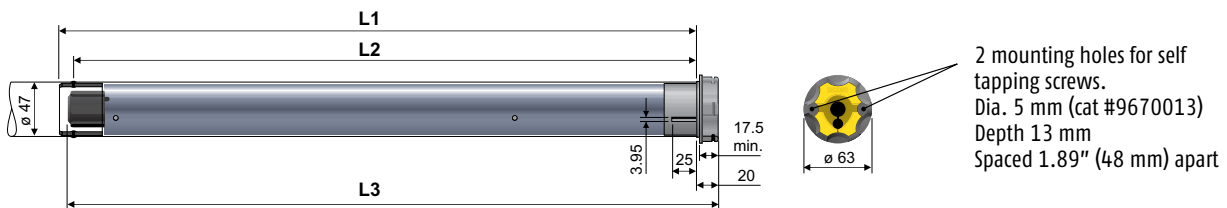

### Performances

	506S2	510S2	525A2	530R2	535A2	540R2	550R2
<b>Torque</b>	6 Nm	10 Nm	25 Nm	30 Nm	35 Nm	40 Nm	50 Nm
<b>Nominal Voltage</b>	120V/60Hz						
<b>Rated Current</b>	1.1A	1.3A	1.6A	1.5A	2.1A	1.8A	2.1A
<b>Speed</b>	38 rpm	38 rpm	20 rpm	14 rpm	20 rpm	14 rpm	14 rpm
<b>Thermal Protection</b>	5 minutes						
<b>Radio Frequency</b>	433.42 MHz	433.42 MHz	433.42 MHz	433.42 MHz	433.42 MHz	433.42 MHz	433.42 MHz

### Dimensions

	506S2	510S2	525A2	530R2	535A2	540R2	550R2
<b>L1</b>	23.82 in (605 mm)	25.79 in (655 mm)	25.79 in (655 mm)	25.79 in (655 mm)	26.57 in (605 mm)	26.57 in (605 mm)	26.57 in (605 mm)
<b>L2</b>	23.23 in (590 mm)	25.20 in (640 mm)	25.20 in (640 mm)	25.20 in (640 mm)	25.98 in (660 mm)	25.98 in (660 mm)	25.98 in (660 mm)
<b>L3</b>	24.13 in (613 mm)	26.10 in (663 mm)	26.10 in (663 mm)	26.10 in (663 mm)	26.89 in (683 mm)	26.89 in (683 mm)	26.89 in (683 mm)
<b>Cable Length</b>	6.5 ft (2 m)	6.5 ft (2 m)	12.3 ft (3.75 m)	6.5 ft (2 m)	12.3 ft (3.75 m)	6.5 ft (2 m)	6.5 ft (2 m)

Optional cables with NEMA plugs available in 3ft, 6ft, 12ft, 18ft, 24ft.

### Type of cable

**RTS**  
**120 V / 60 Hz**  
**3 conductor cable**

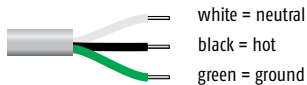

# F.A.Q'S

***When my screen is down I see a light gap below my hem bar, how can I correct that?*** A lot of the times floors are pitched for water drainage causing an uneven surface. Outdoor Shades USA offers thicker hem bar brush for this scenario.

***When my screen runs I hear a screeching noise, how can I correct that?***

- 1) Confirm your tracks are squared and level.
- 2) Spray the PVC inserts with a dry lube such as the one made by Blaster.
- 3) Ensure the fabric is rolling up evenly on the roller tube and not pulling.

***I accidentally chipped the paint, what can I do?***

Outdoor Shades USA offers touch up paint for all its products.

***I need to adjust the limits on my screen and I lost my SOMFY instructions what should I do?***

To change a limit move the motor to its current limit position to be changed and let it stop. Press the UP and DOWN buttons on your remote simultaneously until the motor jogs, then release. Adjust to a new limit position. Press the MY (stop) button until the motor jogs, then release. Check the new limit.

***How do I add a remote/channel, sun or wind sensor?***

First select the remote/channel that is already programmed to the motor and press the program button on the back until the motor jogs. Then select the remote/channel/sun or wind sensor that you would like to add and press the program button on that until the motor jogs.

***My motor does not respond what should I do?***

- 1) Confirm power source (plug another appliance into the same outlet and make sure there is power)
- 2) Make sure you are on the correct channel if you have a Telis 4 or Decoflex 5 remote.
- 3) Does the LED indicator illuminate on the Telis remote? If not change the battery on the remote.
- 4) Press the up and down buttons simultaneously to see if you can wake up the motor.

***Misc. Tips***

- 1) Make sure the fabric is rolling off the top of the roller or the limits will not set correctly.
- 2) Make sure the power cord is not cut shorter than 2 feet.
- 3) Make sure the light is blinking when pressing a button on the Telis remote.

## Maintenance practices

When screen is not in use, it is recommended that it is fully retracted. The screen should remain retracted during high winds.

When lowering screens, make sure it is not obstructed in any way. Obstructions may cause damage to the screen.

When the screen is lowering, if the bottom bar does not lower; ***STOP the screen immediately*** by hitting the “MY” button on your controller.

Motorized screens will not operate during power outages.

Tracks should be free of dirt and debris. Lubricate with a dry silicone spray only on a semi-annual basis.

Mesh screens can be cleaned with a mild detergent and a soft brush. Let screens dry completely before retracting into housing unit.

Do not operate screens in below freezing temperatures.

Do not cook near or expose the screen fabric to high heat.